



CUBIC

BOTANICAL

© SOUTH BANGSAR

RESIDENSI RIMBA

Masterpiece of Men;  
Beautified by Nature

The Figure of  
Cityscape Green Living

**FREEHOLD**



## The Synergy of Modern Cityscape & Nature

---

Cubic Botanical was inspired by the green surroundings of its location, primarily Bukit Gasing / Taman Rimba, surrounded by 200 acres of forest reserves, heavily influencing its green living concept - The Figure of Cityscape Green Living. Its unique and conducive environment allows you to reconnect with nature, enhancing your quality of life.

城市與大自然



## Strategic Location, Everlasting Value 地段就是永恒的價值優勢

Cubic Botanical's prime location near the Pantai Dalam Bangsar South NPE toll allow residents to experience urban city living, with Nexus Bangsar South as the nearest shopping center, followed by Malaysia's largest shopping heaven - Mid Valley Megamall. With just 5 -1 0 minutes of driving, you'll find yourself in either NU Sentral or Sunway Pyramid. Other nearby landmarks include University Malaysia and University Malaya Medical Centre (UMMC), international schools, restaurants and bars, supermarkets, convenience stores and more.

Besides that, a mere 5 minutes walk would bring you to the nearest KTM station, gaining access to KL's main transportation hub - KL Sentral, further connecting you to the international airport KLIA, bringing you unparalleled convenience.

## The Perfect Combination for A Blissful Life

Diving further into the concept of discovering a hidden gem inside the forest city, the facade of the building is inspired by lush greenery that are introduced at the car park podium, creating a visual focal point. The vanishing pattern from the car park podium to the tower's facade create an unifying feature of the landscape and architecture, giving you a radiant and blissful environment.

盡善盡美，幸福生活



*“The presence of light & shadow serves as an important design element for the building's facade.”*

*“...be it the whiff of the wind, the warm rays of the sun, the interplay of organic shadows, the sound of trickling water and the comfort of lush greenery.”*



CUBIC  
**BOTANICAL**  
@ SOUTH BANGSAR  
RESIDENSI RIMBA

## From City to Nature

Inspired by the beauty and elegance of the forest within the city, Cubic Botanical studied the forest's topography and incorporated it into its design, creating a timeless and serene living space.

Surrounded by lush greenery of the forest, this serviced residence is a gem hidden in a timeless forest, waiting to be discovered.

精美设计，回歸大自然



The image shows a high-angle, night-time view of a modern residential building's courtyard. The building has a dark facade with large glass windows, some of which are illuminated from within. In the center of the courtyard is a large, irregularly shaped swimming pool. A prominent feature is a fountain with several tall, thin jets of water that are illuminated with vibrant blue and purple lights. The pool's surface is decorated with large, glowing blue floral patterns. The courtyard is filled with lush greenery, including various trees, shrubs, and ferns. Several people are seen walking on the paved paths around the pool. The overall atmosphere is serene and modern.

## Nature Inspired Residential Facilities

Besides that, lush gardens located on both ground level and facilities level softened the building's outlook, creating a seamless connection between the surrounding forest and the building, a comfortable environment for residents to lead a healthier outdoor living.

灵感于大自然的独特设施



## Enchanted Gardens, Healthy Lifestyle

Like pearls gleaming with light, Cubic Botanical is a gem hidden in Kuala Lumpur South Bangsar, with walking distances that brings you to forest reserves, perfect for nature lovers and family that seeks a healthy and peaceful living. It's strategic location offers wide connectivity via major highways in Klang Valley, ease of commuting, various shopping centers, international schools and entertainment hubs. It's unique concept and connectivity have won the Property Excellence Award at the Sin Chew Business Excellence Awards 2018.

## 5 Unique Zones 鳥語花香，五大設施區域



Aqua Paradise  
Zone



Bird of Paradise  
Zone



Camellia  
Zone



Forest  
Zone



Sky  
Zone

## 22 Residential Facilities

- |                                    |             |
|------------------------------------|-------------|
| 1. BOTANIC LIFESTYLE SWIMMING POOL | 独特设计游泳池     |
| 2. WATER FOUNTAIN                  | 水上喷泉        |
| 3. WADING POOL                     | 儿童戏水池       |
| 4. SUN BED                         | 泳池休闲区       |
| 5. POOL LEDGE                      | 浅池区         |
| 6. NEST PLAYGROUND                 | 鸟巢儿童游乐场     |
| 7. CUBE PLAYGROUND                 | 立方体游乐场      |
| 8. JOGGING TRACK                   | 运动步道        |
| 9. OUTDOOR FITNESS STATION         | 户外健身区       |
| 10. MEDITATION DECK                | 冥想苑平台       |
| 11. RESTING PLAZA                  | 休闲区         |
| 12. REFLEXOLOGY PATH               | 放松小径        |
| 13. CAMELLIA BENCHES               | 茶花景观椅       |
| 14. ROOF TOP BBQ AREA              | 空中烧烤区       |
| 15. LOUNGE AREA                    | 空中聚会区       |
| 16. SILENCE AREA                   | 清静空间        |
| 17. PLAY ROOM                      | 室内游戏厅       |
| 18. CHANGING ROOM                  | 运动休息室       |
| 19. GYMNASIUM                      | 空中健身房       |
| 20. MULTIPURPOSE FUNCTION HALL     | 多功能大厅       |
| 21. COVERED BBQ AREA               | 覆盖式烧烤区      |
| 22. FAMILY "KTV" ROOM              | 家庭式 KTV 娱乐厅 |



“A luxurious ballroom, designed specially for you.”

## Exclusive Amenities for A Better Living



Residential facilities include a 25m Botanic Lifestyle Swimming Pool, and also a gym room that is equipped with the latest workout equipments.

健康生活再升級



*“An enchanting pool environment with a Victorian water fountain.”*

“優美的泳池環境和維多利亞噴泉”



*“...where urban designs combine with Mother Nature, to bring you the best of living.”*

## Rooms & Suites

Each unit is designed to be part of nature, be it the surrounding forest or the lush gardens growing below, residents are sure to be greeted with a picturesque view no matter where they are.



# UNIT PLANS

**TYPE A** (518 sqft)

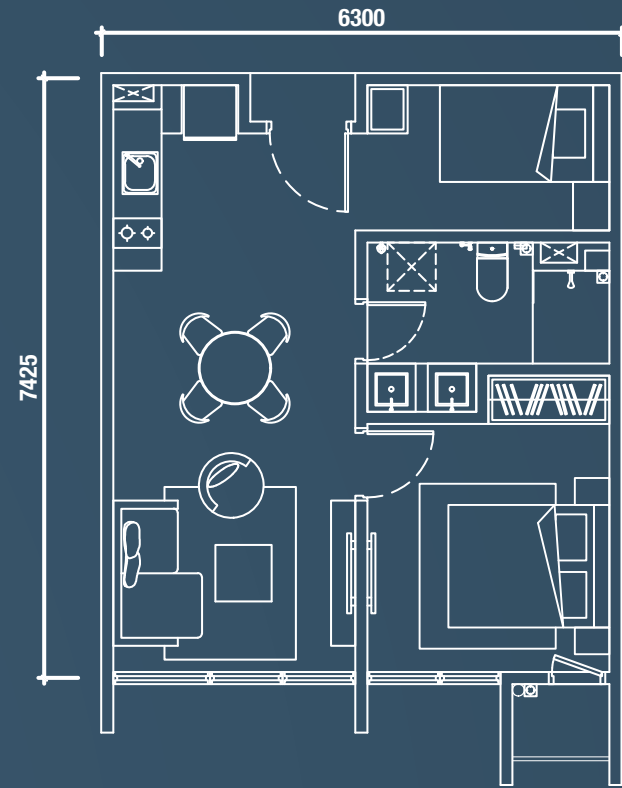

**SUPERIOR SUITE**  
优越單位

**TYPE B1-a** (650 sqft)

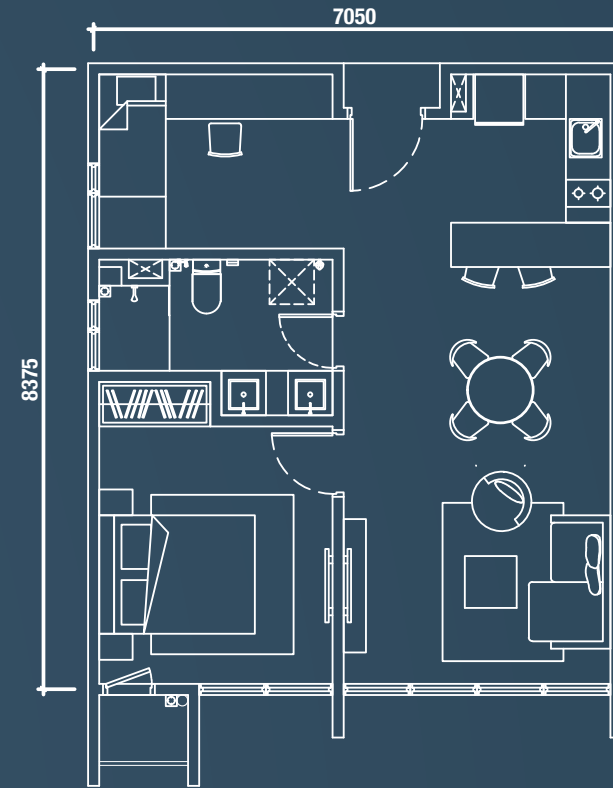

**DELUXE SUITE**  
优越空间單位

**TYPE C** (805 sqft)

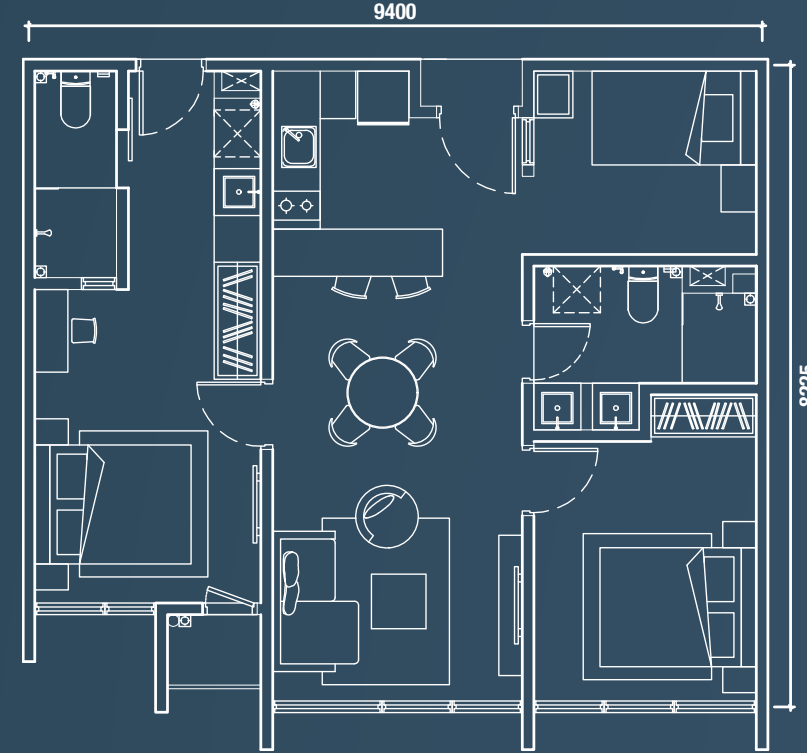

**DUAL KEY SUITE**  
雙鑰匙單位

**TYPE D** (900 sqft)

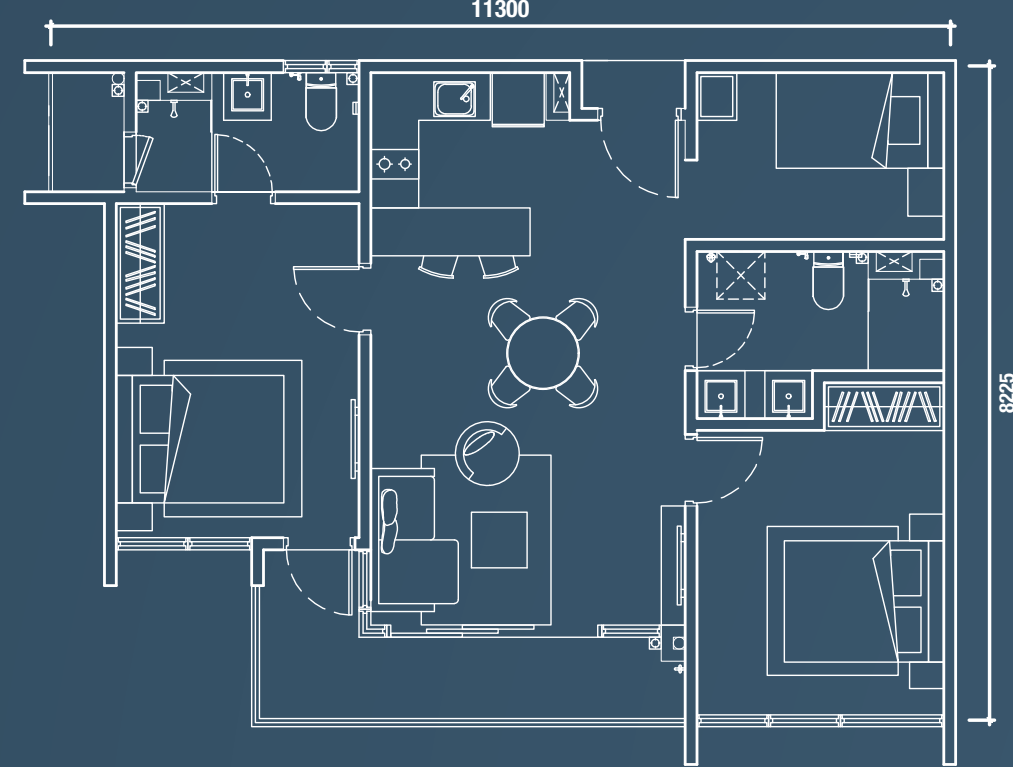

**LUXURIOUS SUITE**  
豪華單位

**Type A** No.

Bedroom 1 + 1

Bathroom 1

**Type B1-a** No.

Bedroom 1 + 1

Bathroom 1

**Type C** No.

Bedroom 2 + 1

Bathroom 2

**Type D** No.

Bedroom 2 + 1

Bathroom 2

# SPECIFICATIONS



## Exquisite Bathrooms

All bathrooms are equipped with a well designed floor trap system to prevent pest from invading.

Penthouse bathroom

(a) Structure	:	Reinforced Concrete Structure
(b) Wall	:	Masonry / Light Weight Concrete Panel / Reinforced Concrete Wall
(c) Roofing Covering	:	Reinforced Concrete Roof or Metal Roof
(d) Ceiling	:	Skim Coat and Paint Plaster Board and Paint (where applicable)
(e) Windows	:	Aluminium Frame Glass Windows
(f) Doors	:	Balcony - Glass Sliding Door Main Door - Fire Rated Door Others - Plywood Door
(g) Ironmongery	:	Quality locksets
(h) Wall Finishes	:	Washroom - Tiles Others - Paint
(i) Floor Finishes	:	All Area - Tiles All Bedrooms & Multipurpose Room - Laminated Timber Ac Ledge - Cement Render
(j) Sanitary and Plumbing Fittings	:	Sanitary Ware - Standard Colour Sanitary Fittings - Chrome Finishes
(k) Electrical Installation	:	
		A & A1-a    A2 & A2-a    B1-a & B1-b    B2-a & B2-b    C, C1-a, C1-b, C1-c    C2, C2-a & C2-b    C3, C3-a & C3-b    D & D1    D2    E    E1    E    F1
	Lighting Point	-    5        5        5        5        8        8        10        8        10        27    30    19    21
	Fan Point	-    3        3        3        3        4        4        3        4        3        6        7        4        4
	Switch Socket Outlet	-    10       10       10       10       15       15       14       13       12       19       20       15       16
	A/C Point	-    2        2        2        2        3        3        3        3        3        4        5        4        4
	Water Heater Point	-    1        1        1        1        2        2        2        2        2        3        3        2        2
	Door Bell Point	-    1        1        1        1        1        1        1        1        1        1        1        1        1
	Smatv Outlet	-    2        2        2        2        3        3        3        3        3        2        2        3        3
(l) Internal Telephone Trunking And Cabling	:	Fiber Wall Socket